

KNAPHEIDE
SINCE 1848

// FORD

SERVICE BODIES

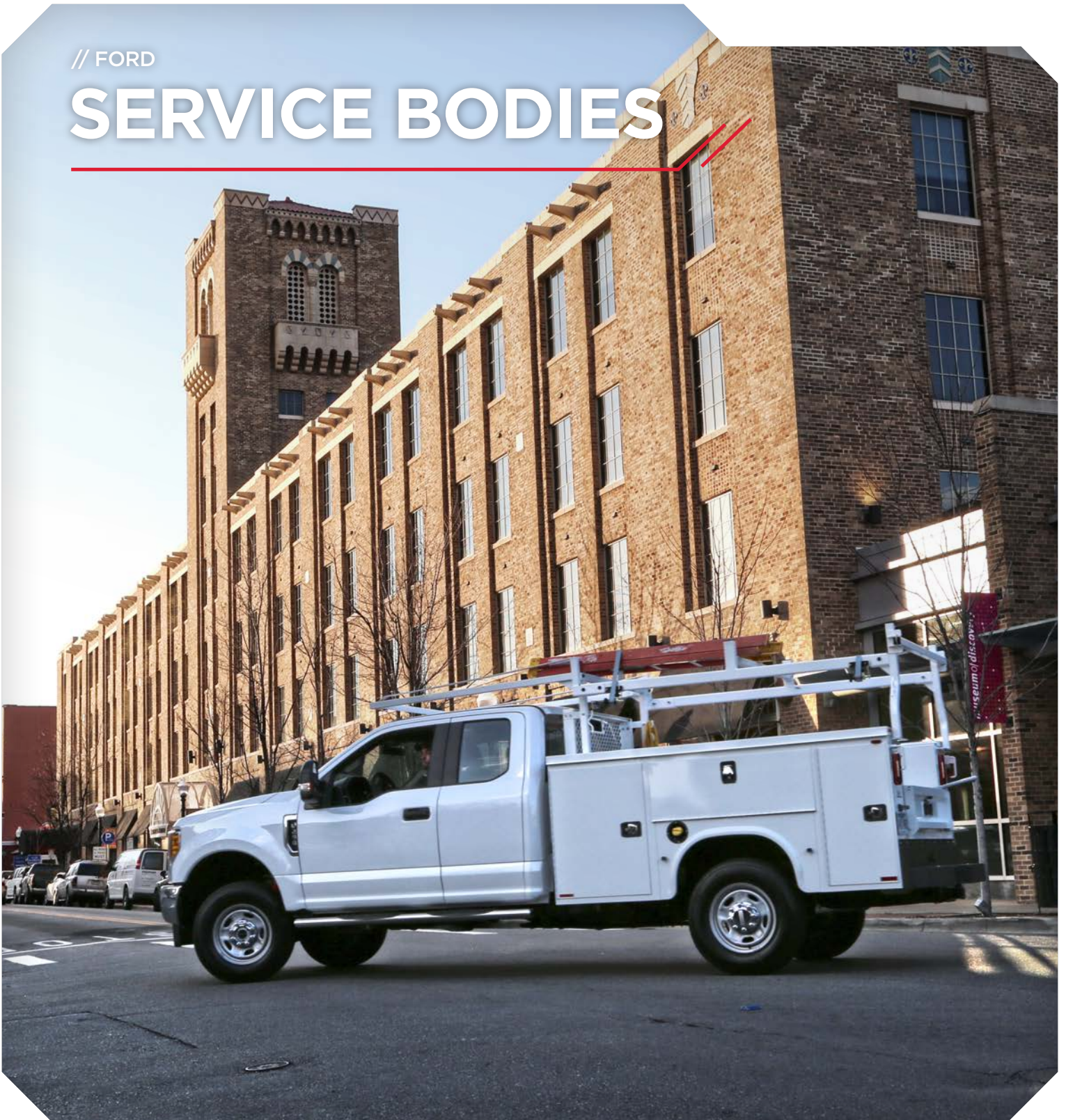

STEEL SERVICE BODIES

With a rugged steel construction and external storage for your tools and equipment, the Service Body is a key component in your day-to-day productivity.

The external compartments offer protection from outside elements and allow technicians to access their equipment without having to climb into the truck bed.

Staying organized both on and between job sites is important. Get maximum efficiency with a Knapheide Service Body.



6108F40
*Body may be shown
with optional features

STANDARD SHELVING

All Knapheide Service Bodies come with the following standard shelving units:

- Two adjustable divider shelves and dividers, in the street and curb side front vertical compartments (1st and 2nd vertical 132" bodies only)
- One adjustable divider shelf and dividers in the street and curb side full height rear vertical compartments
- One adjustable divider shelf and dividers in the curb side horizontal compartment

REQUEST A QUOTE

Visit knapheide.com/quote and fill out the form to receive a quote and additional product information.

STANDARD FEATURES

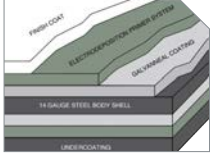

A Features 14-gauge, two-sided A-40 galvalume steel shell



H Features double-shell, 20-gauge, two-sided A-40 galvalume steel compartment doors

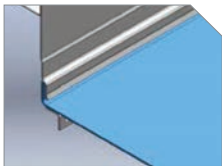

B Exclusive "Return Flange" floor design provides support

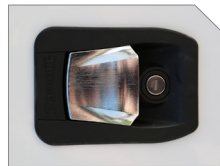

I Automotive-quality, rotary-style latches make opening and closing easy



C Interior light guards protect recessed lighting and wiring



J Interior cover protects internal latch from damage



D Continuous stainless steel hinges are pry-proof and corrosion-resistant

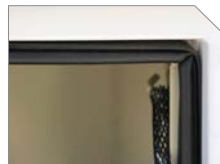

K Neoprene door seals protect compartments from the weather



E Adjustable security ring strikers provide a weather-tight seal



L Quick-mount installation allows for fast, safe mounting



F Includes 250-lb. capacity adjustable divider shelves



M Includes slam-lock tailgate with one-hand center release



G Double-spring over-center door retainer eliminates involuntary door swing



N Upgraded surface mount lighting system features LED S/T/T and B/U, LED strobe option* with (8) selectable patterns, and built-in reflectivity for additional safety**

*Additional wire harness required for strobe lights
**Covered under 3-year limited warranty

// E-COAT PROTECTION:

Electrodeposition prime-paint system provides superior corrosion resistance

ALUMINUM SERVICE BODIES

Aluminum service bodies from Knapheide feature a superior design and innovative construction.

Utilizing military-grade aluminum and structural adhesives are just a few of the features that place our aluminum service bodies far ahead of the competition.

In order to provide customers with the utmost confidence in our aluminum service bodies, we put them through the most rigorous testing program in history. They were subjected to the harshest environments and applications possible in our lab, on proving grounds — and by real customers like you.

Choose a Knapheide Aluminum Service Body and you'll get corrosion resistance, increased payload, and an aluminum service bed that is just as durable as steel.

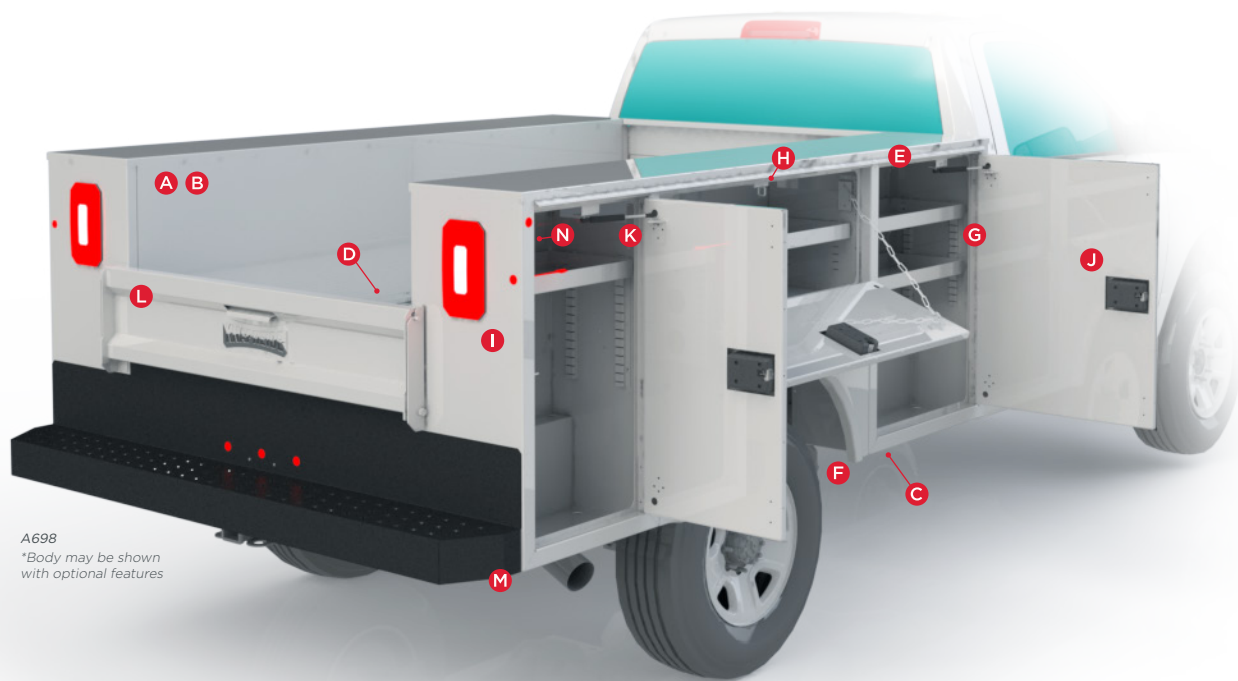

STANDARD SHELVING

All Knapheide Service Bodies come with the following standard shelving units:

- Two adjustable divider shelves and dividers, in the street and curb side front vertical compartments (1st and 2nd vertical 132" bodies only)
- One adjustable divider shelf and dividers in the street and curb side full height rear vertical compartments
- One adjustable divider shelf and dividers in the curb side horizontal compartment

REQUEST A QUOTE

Visit knapheide.com/quote and fill out the form to receive a quote and additional product information.

STANDARD FEATURES



- A** Constructed of 6061 T6 and 5052 aluminum



- H** Adjustable security ring strikers provide a weather-tight seal

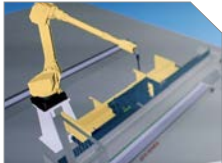

- B** Aerospace design and assembly for unmatched durability



- I** Upgraded surface mount lighting system features LED S/T/T and B/U, LED strobe option with (9) selectable patterns, and built-in reflectivity for additional safety

**Additional wire harness required for strobe lights
Lights covered by 3-year limited warranty



- C** All-aluminum 6061 T6 understructure



- J** Automotive-quality rotary latches with easy open handle and interior cover



- D** Floor constructed of rugged 6061 T6 aluminum extrusions and exclusive "Return Flange" floor design



- K** Nitrogen strut door retainers



- E** Inset door frame design with double tray aluminum doors and neoprene seals for weather-tight closing



- L** Includes slam-lock tailgate with one-hand center release



- F** TPO fender skirts



- M** Quick-mount installation allows for fast, safe mounting



- G** Continuous aluminum hinge with stainless steel rods



- N** Interior light guards protect recessed lighting and wiring

COMPARTMENT CONFIGURATIONS



// 500 SERIES COMPARTMENTS

The 500 Series Service Bodies feature a horizontal compartment that stretches from the first vertical compartment to the end of the body with a small, rear lower compartment.



// 600 SERIES COMPARTMENTS

The 600 Series Service Bodies feature a horizontal compartment that is positioned over the wheel well and one vertical compartment in the front of the body and one at the rear of the body.

// 700 SERIES COMPARTMENTS

The 700 Series has 500 Series configuration on the curb side and 600 Series on the street side.

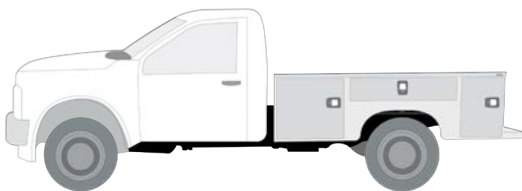

// LOW PROFILE BODY

Low Profile Bodies, denoted by “LP”, offer greater visibility from the cab while only sacrificing 4” of the body height compared to a standard Service Body.

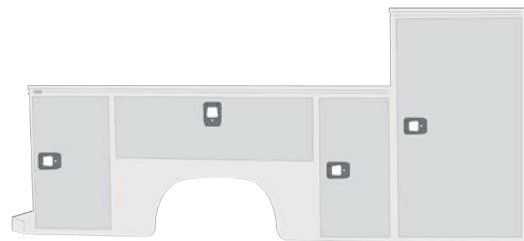

// RAISED FRONT COMPARTMENTS

Raised front vertical compartment configuration raises the curb side front vertical compartment to 60” tall.



// **FLIP TOP COMPARTMENTS**

Flip Tops, denoted by “F”, allow for greater internal storage, organization and flexibility. Knapheide’s Flip Tops have a slammable top lid door and a convenient one-hand release located in the horizontal compartment.



// **PLUS 50 COMPARTMENTS**

Plus 50 models feature a transverse compartment in the curb side front vertical extending to the street side compartment in the back. Plus 50 models have 50% more effective storage capacity.

Depending on body model, compartments have either two or three drawers, 59” or 69” long. All drawers are rated for 250-lb. and have dividers every 4”.

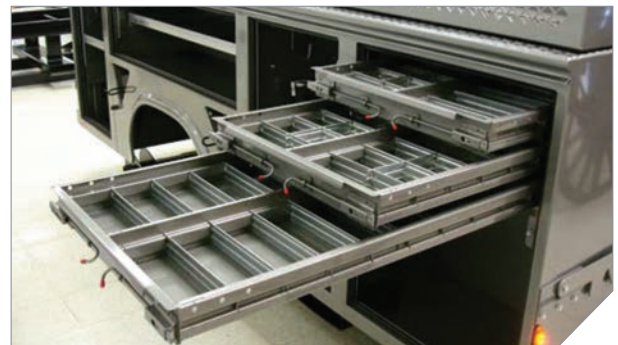

THREE-DRAWER UNIT



TWO-DRAWER UNIT

POPULAR OPTIONS

// BUMPERS

Knapheide bumpers are constructed with work in mind. With three configurations and three surface options (tread plate, Galva-Grip, and grip strut), we have a bumper for every need. Select bumpers available with Knap-liner coating for additional grip and durability.

Bumpers for aluminum bodies are available in Knap-liner coating only.

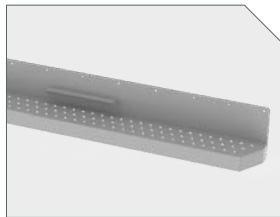

STRAIGHT BUMPERS

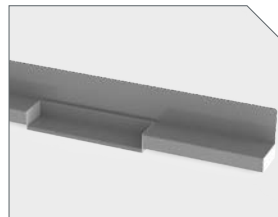

STEP BUMPERS

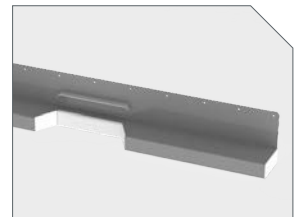

HITCH RECESS BUMPERS

// CANOPY ROOF

The canopy roof option allows you to fully enclose your cargo area. Canopy roofs are available in three heights, straight sides, and with stationary or telescopic roofs. For a tapered-side one-piece body design, take a look at our KUVcc product line.

Not available for aluminum bodies.

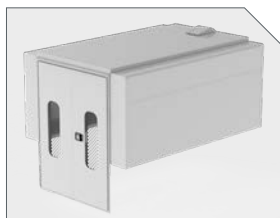

STRAIGHT SIDES

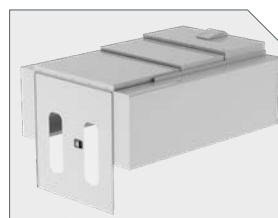

TELESCOPIC ROOF

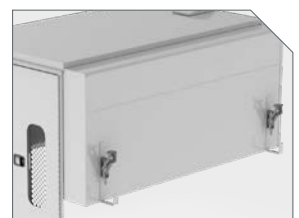

SIDE LADDER RACKS



SIDE ACCESS DOORS

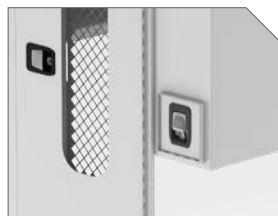

REAR ACCESS DOOR



// TELESCOPIC SLIDING ROOF

Telescopic sliding roofs offer a robust enclosure for the cargo space of your Service Body, allowing you to protect your tools and equipment from theft and weather.

Not available for aluminum bodies.

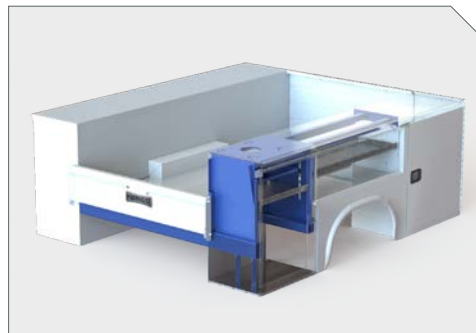

// CRANE REINFORCEMENT KIT

The crane reinforcement kit option allows you to incorporate a crane up to 4,000 lb. capacity (16,000 ft-lb. max.) onto the rear curb side corner of your body.

Not available for aluminum bodies.

// RACKS

Adding a rack to your Service Body increases your storage space by getting your ladders and other long tools or equipment up and out of the way, making room to haul more items in your cargo area.



KNAPHEIDE UTILITY RACK*



OVERCAB MATERIAL RACK*
(KARGO MASTER)



SIDE MOUNT LADDER RACK



OVERHEAD LADDER RACK*

NOT PICTURED (APPLIES TO SIDE MOUNT & OVERHEAD LADDER RACKS):

• **LADDER RACK ROLLERS**

• **LADDER RACK RAILS**

**Not available for aluminum bodies*

// SECURITY



MASTER LOCKS



POWER LOCKS

// LIGHTING



FRONT STROBE

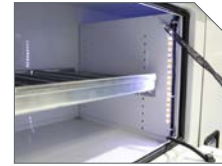

LED COMPARTMENT LIGHTS

// SAFETY



GRAB HANDLES



CABLE STEPS*

// STORAGE/ORGANIZATION



ALUMINUM DRAWERS



STEEL DRAWERS*



FLEX STEPS



WHEEL CHOCK HOLDER - FENDER SKIRT



SORTIMO COMPARTMENT STORAGE/MOBILITY

// EXTERIOR OPTIONS



ROCK GUARDS



ALUMINUM TREAD PLATE TRIM KITS

// SHELVES



PULL-OUT SHELVES*



PULL-OUT TRAY



MODULAR CAB GUARD



MOUNTING KITS FOR REMOVABLE CRANE* (SPITZLIFT)



METER TRAY WITH HOLES

// DOOR OPTIONS



**SINGLE POINT
OR THREE POINT
T-HANDLE**



**REAR ACCESS
DOOR**

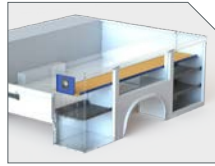

**REAR ACCESS
DOOR WITH FULL-
LENGTH SHELF**

// CARGO AREA



**E-TRACK &
ACCESSORIES**



**BOTTLE GAS
RETAINER**



**CARGO
TIE-DOWNS**

(Pictured in steel.
In-floor swivel D-rings
available in aluminum.)

// SERVICE BODY PACKAGES

Need your work truck fast? These preconfigured packages are built for quicker delivery to you. Ask your Knapheide rep for more information.

1848 PACKAGE

- Painted white
- Lights installed and wired
- Power locks installed
- LED compartment lights installed
- Sortimo BOXX package in left horizontal compartment
- Aluminum tread plate rock guards and tailgate trim installed

PIONEER PACKAGE

- Painted white
- Lights installed and wired
- Masterlocks installed
- Aluminum tread plate rock guards installed
- Aluminum tread plate trim kit installed: includes tops of compartments and tailgate



COMMITMENT TO CORROSION RESISTANCE

Corrosion won't be a concern when you buy quality Knapheide products.

To give you the best corrosion protection on our steel bodies, we utilize a state-of-the-art, custom-designed, 12-step, SST cathodic electrodeposition finishing system, called "E-Coat."

It bonds prime paint to steel by an electroplating process to give you a superior coat of primer, resulting in better corrosion protection compared to spraying methods.

Aluminum bodies are naturally corrosion resistant. Where steel fasteners are used, those fasteners are coated with "EcoGuard" to eliminate the interaction between the steel and aluminum.

The E-coat system and aluminum assembly method both allow us to create products with the highest level of corrosion resistance available.

**Not available for aluminum bodies*

TRUCK	CAB	GVWR
X2A/X2B	Super	10,000 lb.
W2A/W2B	Crew	10,000 lb.
X3A/X3B	Super	10,000/11,500 lb.
W3A/W3B	Crew	10,000/11,500 lb.

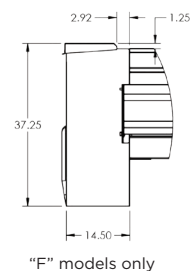

// 56" CA SINGLE REAR WHEEL

TRUCK	CAB	GVWR
F2A/F2B	Regular, Gas	9,800/10,000 lb.
X2A/X2B	Super	9,900/10,000 lb.
W2A/W2B	Crew	9,900/10,000 lb.
F3A/F3B	Regular, Gas	10,000/11,500 lb.
X3A/X3B	Super	10,000/11,500 lb.
W3A/W3B	Crew	10,900/11,500 lb.

// 56" CA DUAL REAR WHEEL

TRUCK	CAB	GVWR
F3C/F3D	Regular	11,800/13,000 lb.
X3C/X3D	Super	12,200/13,000 lb.
W3C/W3D	Crew	12,600/13,000 lb.

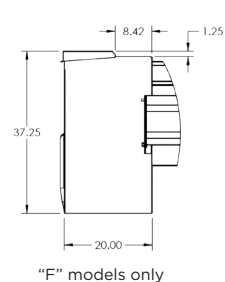

// 60" CA SINGLE REAR WHEEL

MODEL	TYPE	HEIGHT	WEIGHT
6108	Standard	40"	1,238 lb.
6108LP	Low Profile	36"	1,176 lb.
6108F	Flip Top (L)	37.25"	1,311 lb.
6108F40	Flip Top (H)	41.25"	1,374 lb.

TRUCK	CAB	GVWR
F3E/F3F	Regular	9,800/11,500 lb.
X3E/X3F	Super, Gas	9,800/11,500 lb.
W3E/W3F	Crew	10,900/11,500 lb.

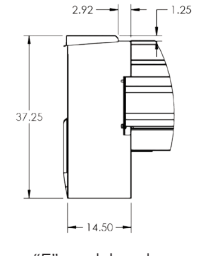
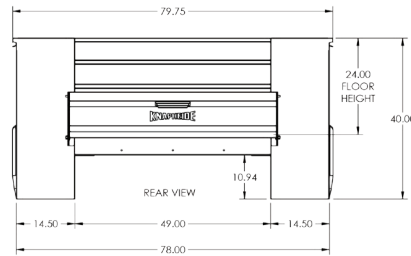
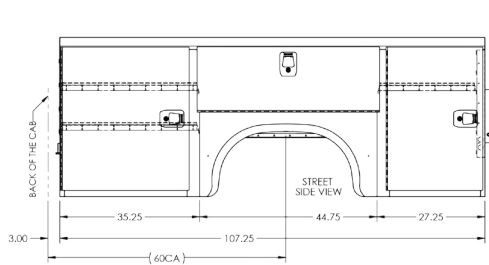

"F" models only

// 60" CA DUAL REAR WHEEL

MODEL	TYPE	HEIGHT	WEIGHT
6108D54	Standard	40"	1,399 lb.
6108D54LP	Low Profile	36"	1,366 lb.
6108D54F	Flip Top (L)	37.25"	1,471 lb.
6108D54F40	Flip Top (H)	41.25"	1,530 lb.
6108XW*	Standard	40"	1,363 lb.
6108XWF*	Flip Top	37.25"	1,434 lb.

*XW models denote 65" wide floor and 14.5" deep compartments

TRUCK	CAB	GVWR
F3G/F3H	Regular	14,000 lb.
X3G/X3H	Super	14,000 lb.
W3G/W3H	Crew	14,000 lb.
F4G/F4H	Regular	15,000/16,500 lb.
X4G/X4H	Super	15,000/16,500 lb.
W4G/W4H	Crew	15,000/16,500 lb.
F5G/X5H	Regular	17,950/19,000 lb.
X5G/X5H	Super	17,950/19,000 lb.
W5G/W5H	Crew	17,950/19,000 lb.

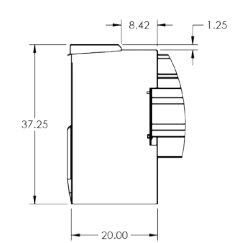
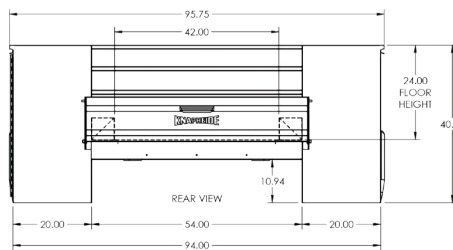
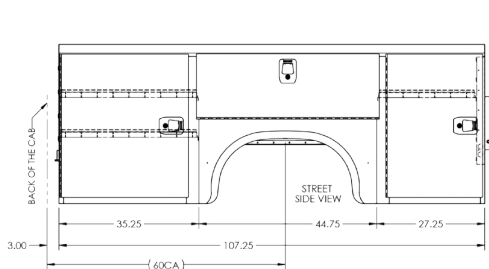

"F" models only

// 84" CA DUAL REAR WHEEL

MODEL	TYPE	HEIGHT	WEIGHT
6132D54	Standard	40"	1,704 lb.
6132D54LP	Low Profile	36"	1,626 lb.
6132D54F	Flip Top (L)	37.25"	1,791 lb.
6132D54F40	Flip Top (H)	41.25"	1,863 lb.
6132XW*	Standard	40"	1,656 lb.

*XW models denote 65" wide floor and 14.5" deep compartments

TRUCK	CAB	GVWR
F3G/F3H	Regular	14,000 lb.
F4G/F4H	Regular	15,000/16,500 lb.
W4G/W4H	Crew	15,000/16,500 lb.
F5G/F5H	Regular	17,500/19,500 lb.
W5G/W5H	Crew	17,500/19,500 lb.

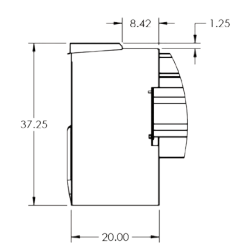
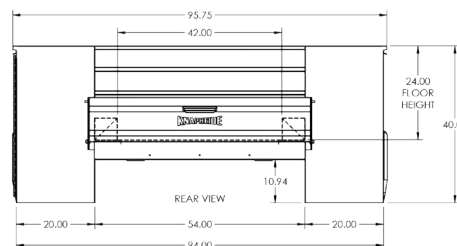
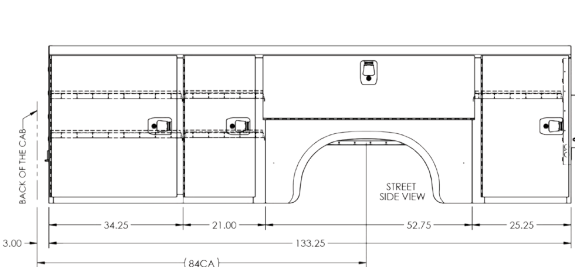

"F" models only

// 40" CA SINGLE REAR WHEEL

MODEL	TYPE	HEIGHT	WEIGHT
A682	Standard	40"	547 lb.
A682LP	Low Profile	36"	520 lb.
A682F	Flip Top (L)	37.25"	621 lb.
A682F40	Flip Top (H)	41.25"	648 lb.

TRUCK	CAB	GVWR
X2A/X2B	Super	10,000 lb.
W2A/W2B	Crew	10,000 lb.
X3A/X3B	Super	10,000/11,500 lb.
W3A/W3B	Crew	10,000/11,500 lb.

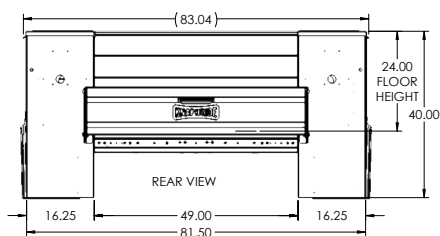
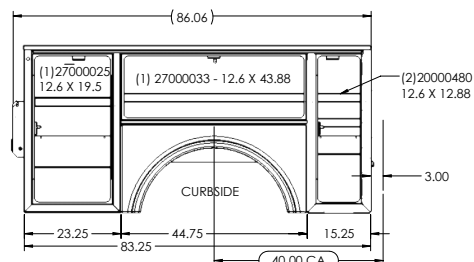

// 56" CA SINGLE REAR WHEEL

MODEL	TYPE	HEIGHT	WEIGHT
A698	Standard	40"	630 lb.
A698LP	Low Profile	36"	600 lb.
A698F	Flip Top (L)	37.25"	720 lb.
A698F40	Flip Top (H)	41.25"	750 lb.
A698D41	Standard	40"	637 lb.
A698D41LP	Low Profile	36"	608 lb.
A698D41F	Flip Top	37.25"	742 lb.

TRUCK	CAB	GVWR
F2A/F2B	Regular	9,800/10,000 lb.
X2A/X2B	Super	9,900/10,000 lb.
W2A/W2B	Crew	9,900/10,000 lb.
F3A/F3B	Regular	10,000/11,500 lb.
X3A/X3B	Super	10,000/11,500 lb.
W3A/W3B	Crew	10,000/11,500 lb.

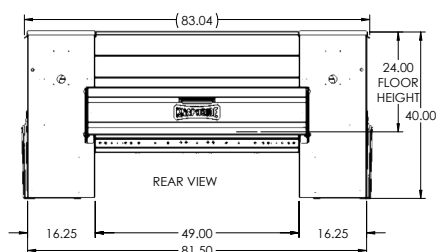
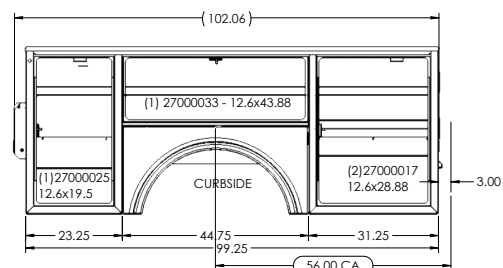

// 56" CA DUAL REAR WHEEL

MODEL	TYPE	HEIGHT	WEIGHT
A698D54	Standard	40"	703 lb.
A698D54LP	Low Profile	36"	671 lb.
A698D54F	Flip Top (L)	37.25"	808 lb.
A698D54F40	Flip Top (H)	41.25"	836 lb.

TRUCK	CAB	GVWR
F3C/F3D	Regular	11,800/13,000 lb.
X3C/X3D	Super	12,200/13,000 lb.
W3C/W3D	Crew	12,600/13,000 lb.

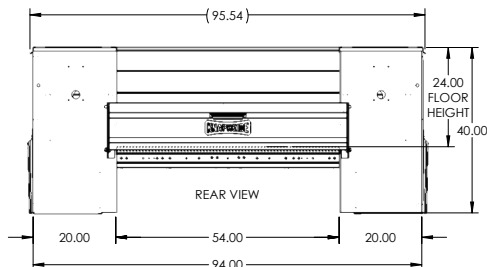
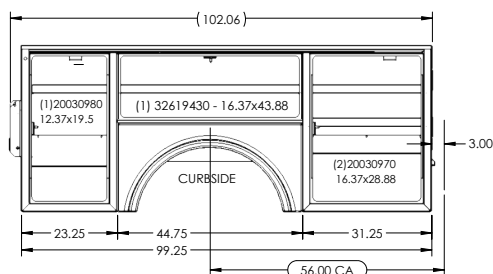

// 60" CA SINGLE REAR WHEEL

MODEL	TYPE	HEIGHT	WEIGHT
A6110	Standard	40"	681 lb.
A6110LP	Low Profile	36"	649 lb.
A6110F	Flip Top (L)	37.25"	780 lb.
A6110F40	Flip Top (H)	41.25"	812 lb.

TRUCK	CAB	GVWR
F3E/F3F	Regular	9,800/11,500 lb.
X3E/X3F	Super	9,800/11,500 lb.
W3E/W3F	Crew	9,800/11,500 lb.

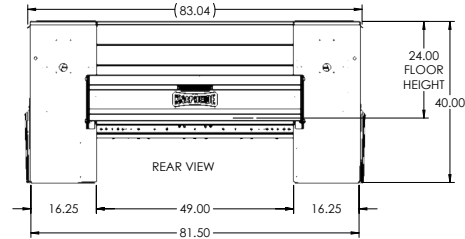
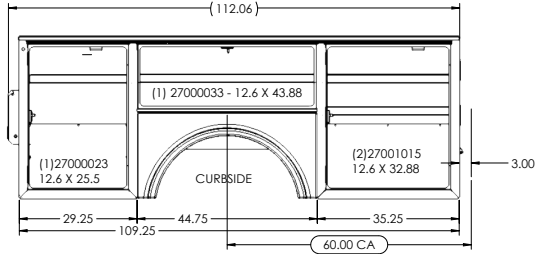

// 60" CA DUAL REAR WHEEL

MODEL	TYPE	HEIGHT	WEIGHT
A6110D54	Standard	40"	764 lb.
A6110D54LP	Low Profile	36"	725 lb.
A6110D54F	Flip Top (L)	37.25"	872 lb.
A6110D54F40	Flip Top (H)	41.25"	907 lb.

TRUCK	CAB	GVWR
F3G/F3H	Regular	14,000 lb.
X3G/X3H	Super	14,000 lb.
W3G/W3H	Crew	14,000 lb.
F4G/F4H	Regular	15,000/16,500 lb.
X4G/X4H	Super	15,000/16,500 lb.
W4G/W4H	Crew	15,000/16,500 lb.
F5G/X5H	Regular	17,950/19,000 lb.
X5G/X5H	Super	17,950/19,000 lb.
W5G/W5H	Crew	17,950/19,000 lb.

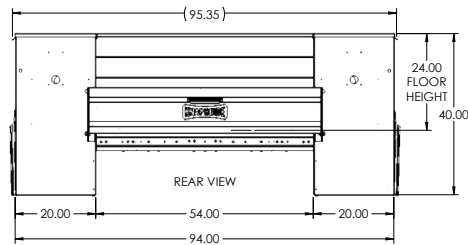
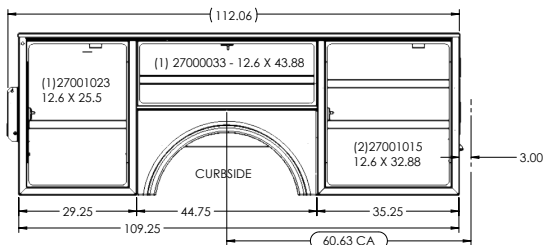

// 84" CA DUAL REAR WHEEL

MODEL	TYPE	HEIGHT	WEIGHT
A6132D54	Standard	40"	902 lb.
A6132D54LP	Low Profile	36"	862 lb.
A6132D54F	Flip Top (L)	37.25"	1,033 lb.
A6132D54F40	Flip Top (H)	41.25"	1,073 lb.

TRUCK	CAB	GVWR
F3G/F3H	Regular	14,000 lb.
F4G/F4H	Regular	15,000/16,500 lb.
W4G/W4H	Crew	15,000/16,500 lb.
F5G/F5H	Regular	17,500/19,500 lb.
W5G/W5H	Crew	17,500/19,500 lb.

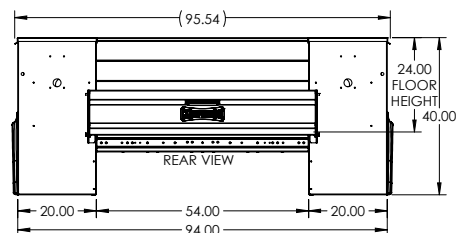
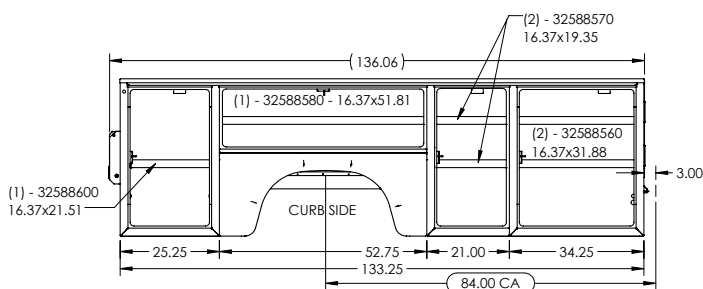

NEVER SETTLE //

If you are going to be a leader, it takes more than building a high-quality product. It means never being totally satisfied with that product, no matter how high quality it may be. It requires constant vigilance and a willingness to take a chance on something new. And it means exceeding expectations every time. As the industry changes, one thing never will—our commitment to making customers like you as productive and efficient as possible. We know you don't settle, and we don't either. That's why we want you never to settle for anything less than Knapheide on the back of your truck.

Knapheide. Never settle.

SIX-YEAR, LIMITED WARRANTY

STEEL SERVICE BODIES



NO RUST
THROUGH



DOOR HINGES WILL
NOT FAIL OR COME
OFF BODY



LATCHES AND LOCK
CYLINDERS WILL NOT
FAIL TO OPERATE



SHELVES WILL NOT
BEND UNDER MAX.
LOAD OF 250 LBS.

TEN-YEAR, LIMITED WARRANTY

ALUMINUM SERVICE BODIES



SHELVES WILL NOT
BEND UNDER MAX.
LOAD OF 250 LBS.

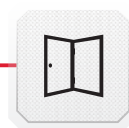

DOOR HINGES WILL
NOT FAIL OR COME
OFF BODY



LATCHES AND LOCK
CYLINDERS WILL NOT
FAIL TO OPERATE



NO FAILURE DUE
TO CORROSION

Visit www.knapheide.com/warranty for more information.



The Knapheide Manufacturing Company
1848 Westphalia Strasse | Quincy, IL 62305

217-222-7131
www.knapheide.com

KNAPHEIDE
SINCE 1848